

Wecco® fittings and pup joints

Wecco® fittings and pup joints have been optimized for minimum weight and size. These rugged products are ideal for handling a complete range of standard and sour gas well servicing fluids at pressures up to 20,000 psi.

Available in 1 to 4-inch sizes, both fittings and pups feature forged construction with integral Wecco® wing union ends for a high-strength, high-integrity connection every time. Wecco® pups and fittings come with full material traceability and can be supplied with Charpy impact values. Like all pressure containing products, Wecco® pups and fittings require special handling (See Warnings).

Wecco® fittings

Up to 20,000 psi cold working pressure; 1 to 4-inch bore sizes

Recommended service

High-pressure well servicing lines, fracturing lines, testing lines, cementing and circulating lines, and other well service and stimulation applications

- 1. Forged construction with full traceability**
- 2. Optimized, lightweight designs**
Save valuable weight and space.
- 3. Complete range of configurations**
Tees, elbows, crosses, wyes, and laterals can be combined to suit virtually any application.
- 4. Integral Wecco® wing union end connections**
High-strength, high integrity connections every time.

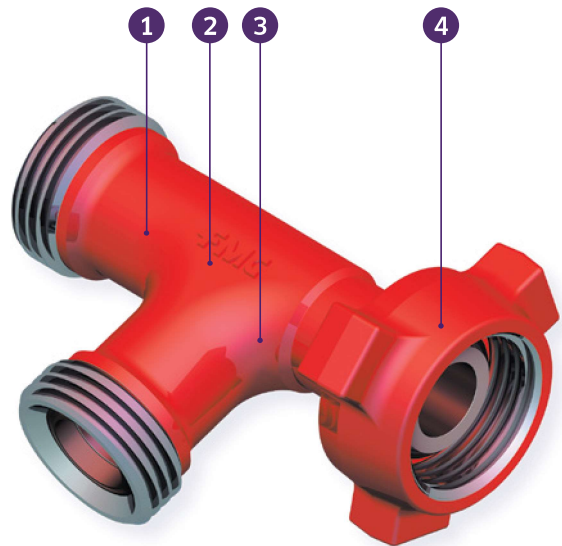

Weco® pup joints

Up to 20,000 psi cold working pressure; 1, 1½, 2, 3, and 4-inch bore sizes, lengths to 20 feet

Recommended service

High-pressure well servicing lines, fracturing lines, testing lines, cementing and circulating lines, and other well service and stimulation applications.

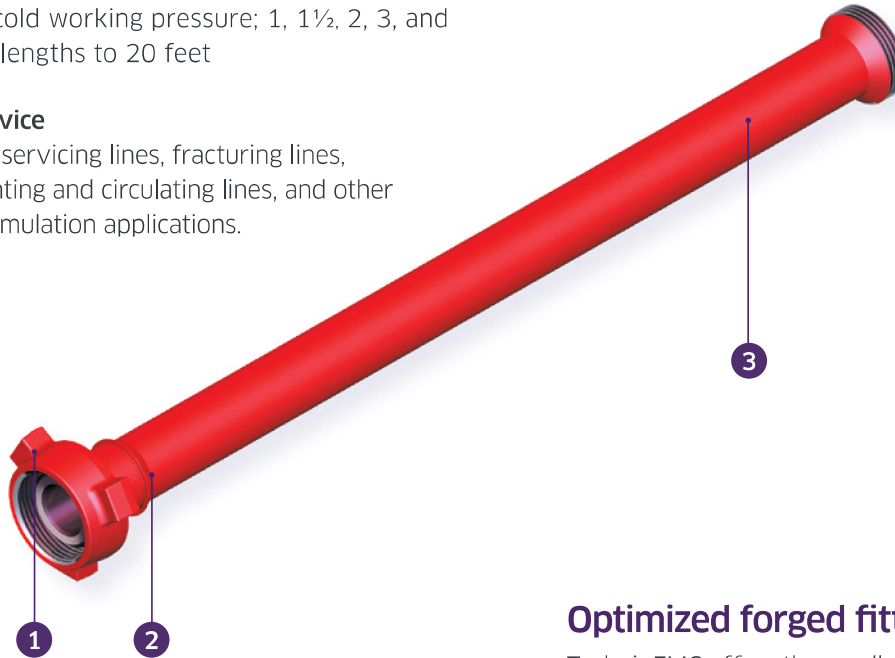

1. Weco® wing union nut detaches for field repair

Permits fast, easy service at the job site.

- ▶ Standard on Integral design.
- ▶ Optional on NPST design.

2. Patented retention shoulder prevents nut from sliding down pup

- ▶ Design decreases risk of injury to personnel.
- ▶ Standard on Integral design. Optional on NPST design.
- ▶ Optional on NPST design.

3. Integral and NPST designs

Available in integral and non-pressure seal designs to suit virtually all oilfield applications.

Optimized forged fittings

TechnipFMC offers the smallest, lightest integral forged fittings on the market. To minimize the size and weight of each fitting, engineers performed a finite element stress analysis on each fitting body design. From these results, the geometry was optimized for weight, and forgings were developed for each size and type of fitting. The fittings were then subjected to laboratory and field testing. The result: You save weight and space without sacrificing service life or safety.

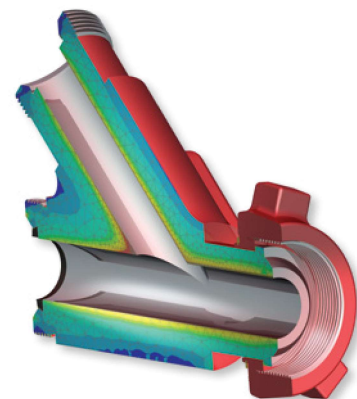

Weco® pup joints

NPS non-detachable nut

Sizes	Weco union end	CWP psi bar	2 ft (610 mm)		3 ft (914 mm)		4 ft (1,219 mm)		5 ft (1,524 mm)		6 ft (1,829 mm)	
			P/N P/N-LT	lb kg	P/N P/N-LT	lb kg	P/N P/N-LT	lb kg	P/N P/N-LT	lb kg	P/N P/N-LT	lb kg
1"	1502	15,000 1034	P515014	15	3265578	18	3265579	21	3265580	24	3262631	27
			P515014-LT	6.8	3265578-LT	8.2	3265579-LT	9.5	3265580-LT	10.9	3262631-LT	12.2
1.5"	1502	15,000 1034	3256224	29	3265598	35	3254968	42	3265599	48	3265600	93
			3256224-LT	13.2	3265598-LT	15.9	3254968-LT	19.1	3265599-LT	21.8	3265600-LT	43
2"	602	6,000 414	CF*	–	P528321	34	CF*	–	P528320	48	3265733	55
					P528321-LT	15			P528320-LT	22	3265733-LT	25
2"	1502	15,000 1034	3255329	31	3255328	38	3255522	45	3255327	52	3255524	59
			3255329-LT	14.1	3255328-LT	17.2	3255522-LT	20.4	3255327-LT	23.6	3255524-LT	26.8
3"	602	6,000 414	3268620	49	3267340	63	3267722	78	3267339	92	P501345	106
			3268620-LT	22.2	3267340-LT	28.6	3267722-LT	35.4	3267339-LT	41.7		48.1
3"	1502	15,000 1034	3255323	55	3255322	69	3255380	84	3255321	98	3255379	112
			3255323-LT	24.9	3255322-LT	31.3	3255380-LT	38	3255321-LT	44.5	3255379-LT	50.8
4"	602	6,000 414	P507216	70	CF*	–	3251806	95	6101173	136	3251807	157
			P507216-LT	32			3251806-LT	43.1	6101173-LT	62	3251807-LT	71.2
4"	1502	10,000 690	3265769	71	P506629	94	3265771	114	3265772	133	3265773	157
			3265769-LT	32	P506629-LT	43	3265771-LT	52	3265772-LT	60.3	3265773-LT	72

*Consult factory

NPS detachable nut (20 ft (6,096 mm) size: consult factory)

Sizes	Weco union end	CWP psi bar	2 ft 610 mm)		3 ft 914 mm)		4 ft 1,219 mm)		5 ft 1,524 mm)	
			P/N P/N-LT	lb kg	P/N P/N-LT	lb kg	P/N P/N-LT	lb kg	P/N P/N-LT	lb kg
2"	1502	15,000 1034	3265907	31	P513374	38	3265908	45	3265909	52
				14.1	P513374-LT	17.2	3265908-LT	20.4	3265909-LT	23.6
3"	1502	15,000 1034	3267024	38	CF*	–	3267025	84	3267026	99
			3267024-LT	18			3267025-LT	38.1	3267026-LT	44.9
4"	602	6,000 414	CF*	–	CF*	–	CF*	–	P514712	136
									P514712-LT	61.7

*Consult factory

8 ft (2,438 mm)		10 ft (3,048 mm)		12 ft (3,658 mm)		20 ft (6,096 mm)	
P/N P/N-LT	lb kg	P/N P/N-LT	lb kg	P/N P/N-LT	lb kg	P/N P/N-LT	lb kg
3256612 3256612-LT	35 16	3265583 3265583-LT	39 18	P504985 P504985-LT	45 20.4	CF*	45 20.4
3254969 3254969-LT	68 30.8	3256062 3256062-LT	81 36.7	CF*	–	CF*	–
CF*	–	P528319 P528319-LT	82 38	3265739	96 44	CF*	80 36.3
3255326 3255326-LT	73 33.1	3255325 3255325-LT	86 39	3255324 3255324-LT	100 45.4	3265728 3265728-LT	155 70.3
P504506 P504506-LT	135 61.2	3267338 3267338-LT	163 73.9	P501344 P501344-LT	192 87.1	CF*	192 87.1
3255320 3255320-LT	141 64	3255423 3255423-LT	169 76.7	3255381 3255381-LT	198 89.8	3255427 3255427-LT	313 142
P514350 P514350-LT	200 90.7	3251808 3251808-LT	240 109	CF*	–	CF*	–
3265775 3265775-LT	198 89.8	3265777 3265777-LT	240 109	CF*	–	CF*	–

*Consult factory

6 ft 1,829 mm)		8 ft 2,438 mm)		10 ft 3,048 mm)		12 ft 3,658 mm)	
P/N P/N-LT	lb kg	P/N P/N-LT	lb kg	P/N P/N-LT	lb kg	P/N P/N-LT	lb kg
P511842 P511842-LT	59 26.8	P512102 P512102-LT	73 33.1	3265906 3265906-LT	86 39	CF*	CF*
P513301 P513301-LT	113 51.3	CF*	–	3267053 3267053-LT	170 77.1	CF*	–
P514711 P514711-LT	158 71.7	P514713 P514713-LT	200 90.7	P514715 P514715-LT	244 111	3265739 3265739-LT	96 44

*Consult factory

Weco® pup joints

NPS detachable nut with retention shoulder

Sizes	Weco union end	CWP psi bar	2 ft (610 mm)		3 ft (914 mm)		4 ft (1,219 mm)		5 ft (1,524 mm)		6 ft (1,829 mm)	
			P/N P/N-LT	lb kg	P/N P/N-LT	lb kg	P/N P/N-LT	lb kg	P/N P/N-LT	lb kg	P/N P/N-LT	lb kg
2"	1502	15,000 1034	P508589	32	P508590	39	P508591	46	P508592	53	P508593	60
				14.5		17.7		20.9		24		27.2
3"	1502	15,000 1034	P508600	56	P508601	70	P508602	84	P508603	99	P508604	113
				25.4		31.8		38.1		44		51.3
4"	602	6,000 414	CF*	–	CF*	–	P510406	121	P510407	118	P510408	164
								54.9		53.5		174.4
4"	1002	10,000 690	P512866	76	P512867	98	P510400	119	P510401	140	P510402	161
				35		45		54		64		74
4"	1502	15,000 1034	P520514	125	P520515	155	P520520	185	P520521	215	P520522	245
				57		70		84		98		111

*Consult factory

Integral

In"	Weco union end	CWP psi bar	2 ft (610 mm)		3 ft (914 mm)		4 ft (1,219 mm)	
			P/N P/N-LT	lb kg	P/N P/N-LT	lb kg	P/N P/N-LT	lb kg
1"	1502	15,000 1034	3263200	24 10.9	P512501	25 11.3	3262915	31 14.1

Integral with retention shoulder

In"	Weco union end	CWP psi bar	3 ft (914 mm)		4 ft (1,219 mm)		5 ft (1,524 mm)	
			P/N P/N-LT	lb kg	P/N P/N-LT	lb kg	P/N P/N-LT	lb kg
2"	1502	15,000 1034	P516825	41 18.6	P516823 P516823-LT	50 22.7	P516821 P516821-LT	58 26.3
3"	1502	15,000 1034	P517538	73 33.1	P517582	91 41.3	P517664 P517664-LT	108 49
3"	2002	20,000 (1380)	P525539	197 90	P525541	197 90	P525543	295 134
3"	1505	15,000 1034	P556329	81 37	P555669	99 45	P556141	116 53
4"	1502	15,000 1034	CF*	–	P520516	210 95	P518458 P518458-LT	251 114

*Consult factory

8 ft (2,438 mm)		10 ft (3,048 mm)		12 ft (3,658 mm)		20 ft (6,096 mm)	
P/N P/N-LT	lb kg	P/N P/N-LT	lb kg	P/N P/N-LT	lb kg	P/N P/N-LT	lb kg
P508594	71 32	P508595 P508595-LT	87 39.5	P508596	101 45.8	P508598	156 70.8
P508605	142 64.4	P508606	170 77.1	P508607	199 90.3	P508609	313 142
P510409	207 93.9	P510410	249 112	P510411	292 132.4	P512873	463 210
P510403	204 93	P510404	247 113	P510405	293 133	P512105	460 209
P531126	305 138	P513472	365 166	CF*	–	P520526	665 302

*Consult factory

5 ft (1,524 mm)		6 ft (1,829 mm)		8 ft (2,438 mm)		10 ft (3,048 mm)	
P/N P/N-LT	lb kg	P/N P/N-LT	lb kg	P/N P/N-LT	lb kg	P/N P/N-LT	lb kg
3261090	37 16.8	3262229	64 29	3266745	55 25	3261496	67 30.4

6 ft (1,829 mm)		8 ft (2,438 mm)		10 ft (3,048 mm)		12 ft (3,658 mm)	
P/N P/N-LT	lb kg	P/N P/N-LT	lb kg	P/N P/N-LT	lb kg	P/N P/N-LT	lb kg
P516820	67 30.4	P516810	84 38.1	P516485	101 45.8	P516817	118 53.5
P517672	127 58	P517674	160 72.6	P517111	195 88.5	CF*	–
P519441	344 157	–	–	P525905	542 246	P525798	642 291
P556307	133 61	P556310	168 77	P556322	202 92	–	–
–	–	P518450	371 169.2	P518437	453 206	CF*	–

*Consult factory